

VEV-16M/25M/40M

Operating Manual



1. Instructions

1. VEV-M series solenoid vacuum baffle valves are opened and closed by the electromagnetic force and the reset force of the bellows spring component, and are used for opening or separating the airflow in the vacuum system;
2. The suitable working media are clean gases and non-strong corrosive gases;
3. The valves must be used within the allowable pressure range;
4. The power supply used must be consistent with that marked on the product and must be connected by the qualified personnel according to the technical standards for electric equipment.

2. Product Features

1. High reliability -- bellows sealing structure;
2. Long service life -- high starting power and low stand-by power;
3. Corrosion resistance -- made of aluminum alloy, stainless steel and other corrosion resistant materials
4. Light weight -- aluminum alloy valve body and bonnet

3. Technical Parameters

3.1 Performance data

Model	VEV-16M	VEV-25M	VEV-40M
Form of valve	Close		
Operating ambient temperature(°C)	5~40		
Media	Clean and non-strong corrosive gases		
Pressure range(Pa)	1x10 ⁻⁶ ~10 ⁵		
Power supply	Single-phase 200~220V/50~60Hz		
Connection	KF16	KF25	KF40
Power	Starting: 18W/stand-by: 4-7W		
Max. cycle frequency	10 times/min		
Exhaust direction	Free		
Weight (kg)	0.85	0.87	1.04

3.2 Dimensions

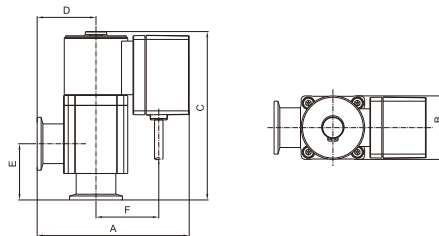

Unit: mm

Model	A	B	C	D	E	F
VEV-16M	115	48	127.3	44.5	42.5	47.5
VEV-25M	115	48	127.3	44.5	42.5	47.5
VEV-40M	118.3	55.5	137.3	47.8	52.5	47.5

4. Disposal

Please safely dispose the valves and remove any parts from the valves in accordance with all local and national (regional) safety and environmental requirements. Do not incinerate fluorine-containing rubber seal rings and O-rings.

5. Warranty

- The warranty period of VEV-M series solenoid vacuum baffle valves is one year since the date of purchase.
- The Company will provide free maintenance services for faults occurring under normal operating conditions as specified in the operating manual within the warranty period.
- The Company will provide paid maintenance services for faults caused in the following conditions:
 - 1) Faults caused by natural disasters or human factors.
 - 2) Faults caused by special operating environments or conditions.
 - 3) Premature failure of O-rings, sealing gaskets and other rubber parts caused by special gases.
 - 4) Faults caused by abnormal operation or improper use identified by the Company's technicians.